

DKL

Double flap ventilator



DKL is the perfect solution when it comes to reliably removing large volumes of warm air and smoke from your building in the shortest possible time. At the same time, the double flap system supports natural ventilation and allows more daylight into the interior, helping to create a pleasant indoor climate. Thanks to flexible installation options – such as on different upstands or in combination with skylights – DKL seamlessly integrates into a wide range of building designs.

Quality and safety are top priorities: Manufacturing in accordance with ISO 9001 standards and compliance with EN 12101-2 ensure the highest European requirements for natural smoke and heat exhaust ventilation systems (NSHEVS). Long-term tests with up to 10,000 opening and closing cycles demonstrate exceptional durability and functionality. The corrosion-resistant aluminum construction ensures minimal maintenance and maximum longevity. Whether pneumatic or electric actuators – DKL offers intuitive and flexible operation. Even large-format models up to 2,500 x 3,500 mm (width x length) deliver uncompromising performance. Versions with ATEX certification and thermally broken profiles are optionally available..

Typische Anwendungen

DKL is particularly recommended for larger building structures such as warehouses, logistics centers, production facilities, and industrial environments. Its versatile applications provide optimal fire protection, effective smoke extraction, and improved indoor air quality – a key component for enhanced safety and efficiency in your operations.

CE CERTIFIED
EN 12101-2 & ATEX Certified

Opening Dimensions

From 1000 x 1000 mm up to 2500 x 3500 mm

Opening Angle

Continuously adjustable between 0° and 90°

Fire Ventilation Control

P2F: Opening and closing via double-acting pneumatic cylinder with thermal fuse
M24V: Crossbar with 24 V motor

Flap Types

- AL** – Single-layer aluminum
- AL ISO** – Double-insulated aluminum (ISO thickness 20 and 100 mm)
- PC16** – 16 mm polycarbonate, clear or opal
- PC25** – 25 mm polycarbonate, clear or opal
- PC32** – 32 mm polycarbonate, clear or opal
- TB** – Thermal break in aluminum profiles (available for AL ISO, PC25 mm, PC32 mm)

Austria

ATTRIA GmbH
ATTRIA production GmbH
Gewerbepark Mitterfeld 7
2523 Tattendorf
AUSTRIA

+43 2254 73734
office@attria-group.com

Germany

ATTRIA GmbH
Am Dorfplatz 1
86489 Deisenhausen
GERMANY

+49 8282 6209180
office@attria-group.de

Southeast Europe

ATTRIA production GmbH
9th of September dist.
Promishlena zona
2227 Bojurishte
BULGARIA

+359 878 550076
office.bg@attria-group.com

Media Owner: ATTRIA GmbH / 2523 Tattendorf

Opening Dimensions

From 1000 x 1000 to 2500 x 3500 mm.

Opening Angle

Continuously up to 90°

Materials

Hardened aluminum AlMg3, seawater and corrosion resistant, extruded aluminum profiles for the frame. Corrosion-resistant bearings.

Optional Surface Treatment

Powder coating, RAL colors

Optional Equipment

Bird and insect protection screens
Fall-through protection

Controls for Smoke Ventilation

P2F: Opening and closing via double-acting pneumatic cylinder with thermal fuse.
M24V: Traverse with 24 V motor.

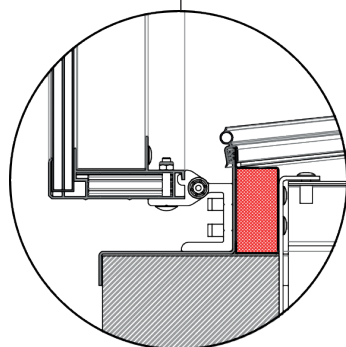
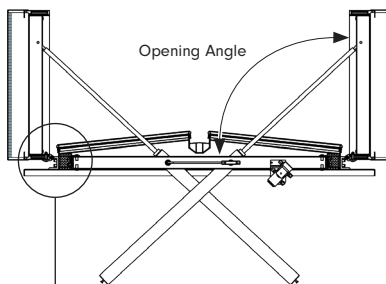
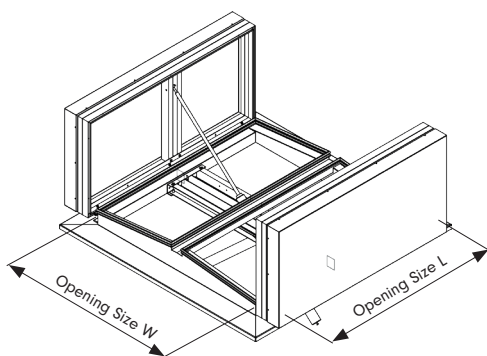
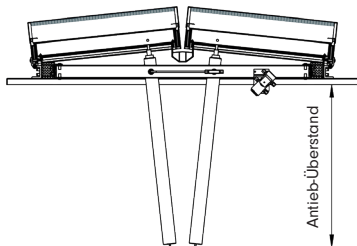
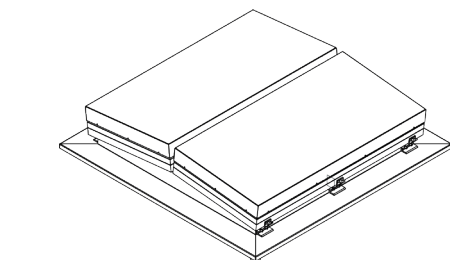

TB - Thermal Break

An optional thermal break in the aluminum profiles prevents the formation of condensation on the inner frame structure. This avoids dripping of condensed water into interior areas below, as well as the formation of mold.

	Opening Size W x L	Roof Pitch	Overhang
min.	1.000 x 1.000 mm	closed 6°	630 mm (electr.)
max.	2.500 x 3.500 mm	open 90°	890 mm (pneum.)

Flap Type

AL - Single-layer aluminum
AL ISO - Double-insulated aluminum (Insulation thickness: 20 and 100 mm)
PC16 - Polycarbonate 16 mm, clear or opal
PC25 - Polycarbonate 25 mm, clear or opal
PC32 - Polycarbonate 32 mm, clear or opal
TB - Thermal break in the aluminum profiles (available for AL ISO, PC25 mm, PC32 mm)

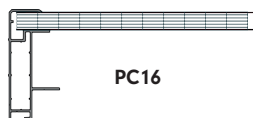

PC16

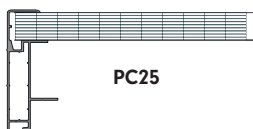

PC25

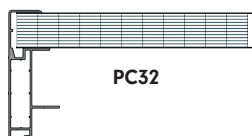

PC32

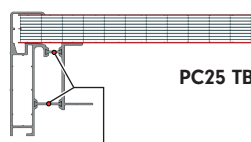

PC25 TB

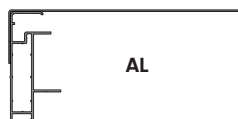

AL



AL ISO 20

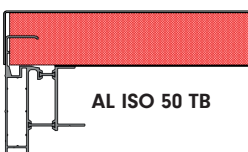

AL ISO 50 TB

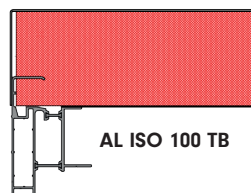

AL ISO 100 TB

	Insulation	
	Thermal U-Value W/m²K	Sound Rw-Value dB
PC16	1,8	21
PC25	1,3	22
PC32	1,1	23
AL	-	-
AL ISO 20	0,8	24
AL ISO 50	0,4	25
AL ISO 100	0,2	27