

BLB

# Barrel vault skylight



Barrel vault skylight strips are the ideal solution for illuminating buildings with natural daylight. They combine functionality, aesthetics, and energy efficiency, creating bright spaces while reducing energy costs. Thanks to high-quality materials and state-of-the-art technology, including thermally broken profiles, they offer optimal thermal insulation and prevent thermal bridging. This advanced construction not only ensures energy efficiency but also contributes to a pleasant indoor climate – regardless of the season.

## Typical Applications

Barrel vault skylight strips have a wide range of applications, such as in commercial, industrial, and logistics centers, where they provide efficient and uniform lighting. They are also suitable for sports halls, shopping centers, and public buildings to create pleasant, well-lit spaces. Even in agricultural buildings, they contribute to an optimal lighting environment.

**CE CERTIFIED**  
**ETA-19/0625****Opening Dimensions:**

Width from 1.000 mm to 6.500 mm

**Glazing:**

Polycarbonate from 10 mm up to 42 mm

**U-Value:**Down to 0.60 W/m<sup>2</sup>K**Thermal Break:**

Ensured by polyamide bars within the profile

**Austria**ATTRIA GmbH  
ATTRIA production GmbH  
Gewerbepark Mitterfeld 7  
2523 Tattendorf  
AUSTRIA+43 2254 73734  
office@attria-group.com**Germany**ATTRIA GmbH  
Am Dorfplatz 1  
86489 Deisenhausen  
GERMANY+49 8282 6209180  
office@attria-group.de**Southeast Europe**ATTRIA production GmbH  
9th of September dist.  
Promishlena zona  
2227 Bojurishte  
BULGARIA+359 878 550076  
office.bg@attria-group.com

Media Owner: ATTRIA GmbH / 2523 Tattendorf

© 2025 ATTRIA GmbH. All contents of this flyer, especially texts, photographs, and graphics, are protected by copyright. Unless explicitly stated otherwise, the copyright is held by ATTRIA GmbH. Subject to change and errors. Illustrations may vary; the actual delivered products may differ in shape and color. The technical data provided is not intended as a basis for planning.

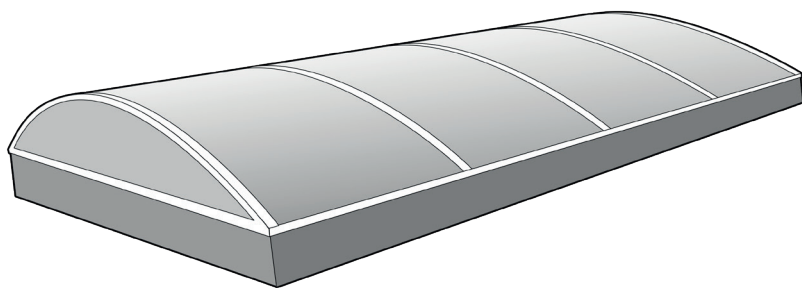

Section  
Side View

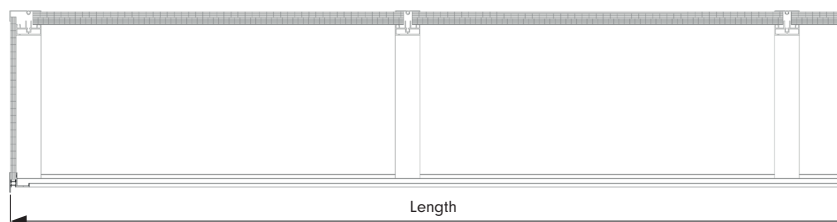

Section  
Front View

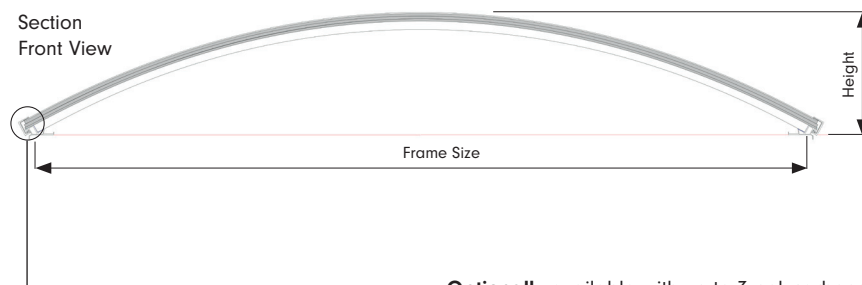

**Optionally** available with up to 3 polycarbonate panels (6 mm, 10 mm, 16 mm), which can be freely combined up to a maximum total thickness of 42 mm.

In this example, the following panels were selected:

2× PC 16 (16 mm each)

1× PC 10 (10 mm)

Total thickness: 42 mm

**Optional thermal separation** through polyamide strips to eliminate thermal bridges.

	Insulation values PC	
	Thermal U-value W/m²K	Sound Rw-value dB
PC 6 Solid sheet	5,0	29
PC 10 Multiwall	2,4	19
PC 16 Multiwall	1,8	21

**Optional fall-through protection.**

Integrated longitudinal profiles are designed to prevent accidental penetration in the event of a fall involving a person.

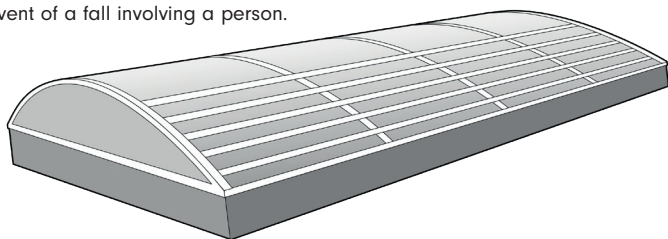

**Optional reinforced mechanical protection.**

Perforated metal sheets offer both fall-through protection and increased durability against external mechanical stress (e.g. hail), along with continuous light protection.

